

Add Jess Combs.  
→ (253) 797-1580

**Trail Committee**  
**Sunday, 19 January 2020**  
**Agenda / Minutes**

**- Introductions**

~ Trail Committee Members present: Dale and Angela McKee, Shannon Reichl, Linda Parry, Courtland Capwell, Scott Gallacher, Mark Michel.

**- Meeting scope and duration**

- The meeting was called to order at 5pm at Seabeck Pizza near Gateway Park.
- The agenda and past minutes were reviewed.

**- Trail Status Update**

**- Existing Trails in 360:**

- Angela reported the equestrian trail in the north section of 360 was dangerous to ride because of animals leaving "post holes." Courtland and Mark advised those holes were prevalent throughout the trail system, and could be fixed in a couple of hours work. Angela and Dale recommended opening up that trail to all-users to increase the likelihood of routine maintenance. The proposal was accepted unanimously.
- Angela also brought up a desire to have more multi-use trails in 360. The Trails Committee unanimously approved a proposal to convert the Southwest perimeter trail to All Uses from one excluding bikes. Courtland said the mountain bike community will build a trail there for all users.
- Additionally, Angela expressed a need for more signage. Scott advised numerous signs had been ordered, received and are being installed.
- Angela asked for signs to be installed on the trails built by the mountain bike community indicating, "These Trails Built and Maintained by The Mountain Bike Community."

**- Existing and proposed new trails in Key Central Forest:**

- Angela and Dale proposed multiple new trails on a map they brought, Attachment A. Scott and Courtland updated the Committee on progress and proposals for additional linking trails and repairs to existing trails. Many of the proposed trails are similar. Scott has hired a contractor to repair the eastern road running north-south (marked "A" on the attached map). Work should start late this month, January 2020, conditions permitting. Scott also indicated Courtland is working on a linking trail depicted as "E" on Attachment A.

**- Trail Naming**

- Signs are being installed in 360 Trails to indicate trail names for existing trails.
- None of the trails in Key Central Forest are named, yet.

**- Parking in Gateway Lot**

- The popularity of Gateway and 360 Trails makes parking a continuing problem. The designated trailer parking area is not being respected as primarily for trailers. Suggestions included placing a sign in the drainage area to the north of the area, painting "Trailer Parking" on the porous grid in the area, placing business cards on cars parking in the trailer parking area as an attempt to further educate the public.

**- Comments**

- Shannon brought up the continuing danger of the exit from Gateway to 302. Scott briefed the committee on the future development of the property to the east of Gateway and the possibility of building a second, safer entrance/exit.

**- Adjournment**

- The meeting was adjourned at 6:20

# Attachment A

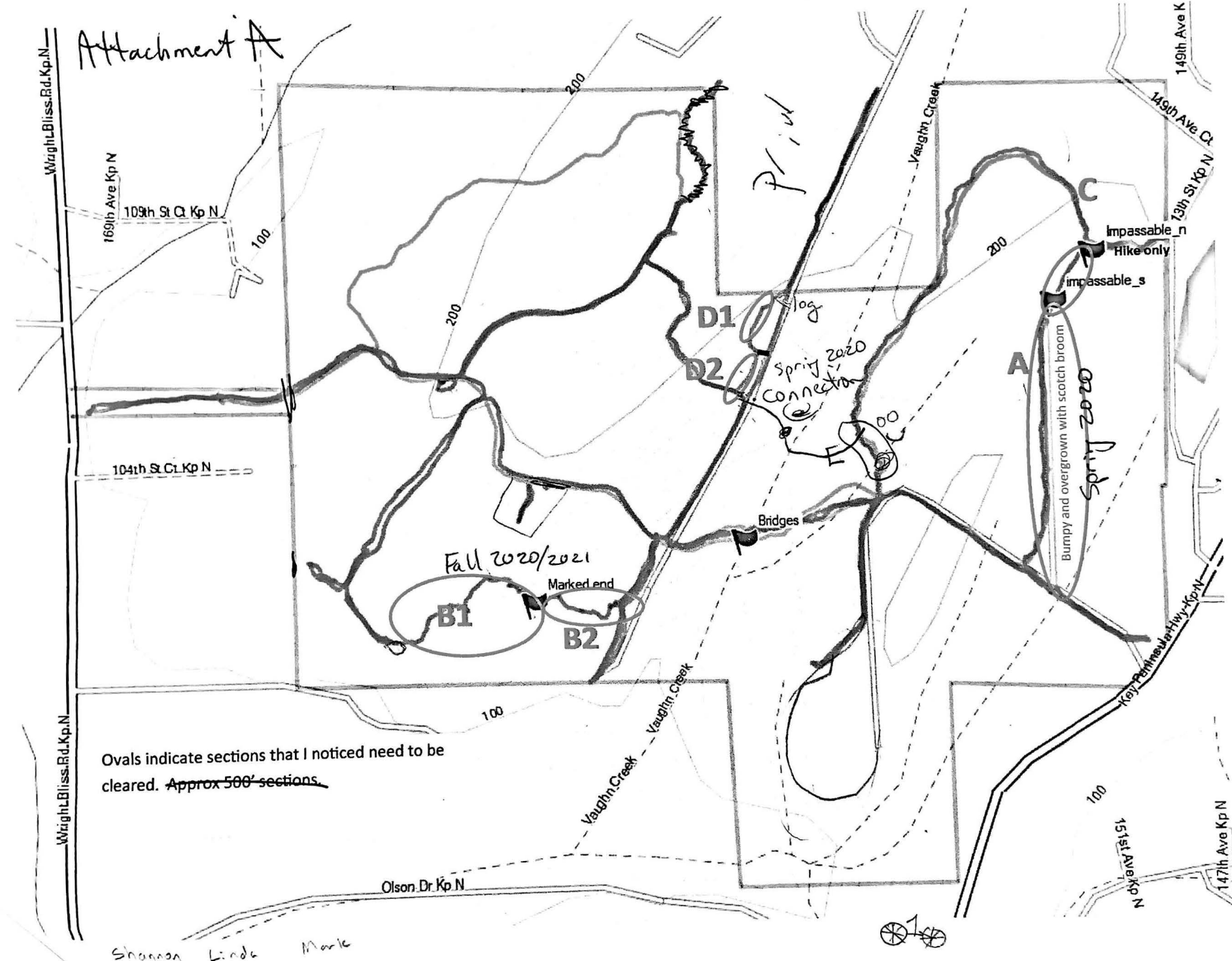

Ovals indicate sections that I noticed need to be cleared. Approx 500' sections.

Shannon Linda Mark  
Caitlan